



Standard Features

Heating Elements

Alloy 800 (UNS08000) Sheath Material, Heavy Wall (.035 In.), Larger Diameter (.475" OD), Sealed Terminals

Spacer /Support

High Temperature Alloy Material, Rugged Design "Evenflow" Configuration

Construction

Welded Heating Elements, Welded Terminal Housing

Service

Wiring Modifiable in Field, Assembly repairable at Factory



Optional Features

Terminal Housings

ER- Explosion Resistant
LT- Liquid Tight
GP- General Purpose

Flange Materials

Carbon Steel, Low Temp Carbon Steel
304SS (L/H), 316SS (L/H)
Inconel 600 / 625, Alloy 800
Hastelloy C, Others

Sensors

Type J,K,E Thermocouples
100 Ohm RTD's
Simplex or Duplex
Optional Tube Wells

Certifications

CSA
ATEX
CRN
UL
IEC eX

Applications

60 and 45 Watts Per Square Inch
For heating clean water only in commercial and/or residential applications.

30 and 35 Watts Per Square Inch
For Fuel Gas, low temperature air and gas heating

23 and 20 Watts Per Square Inch
For heat transfer oil, cleaners, high temperature air and gas heating.

15 and 12 Watts Per Square Inch
For lubricating oils, medium viscosity oils, high temperature air and gas heating.

8 and 6 Watts Per Square Inch
For #5 and #6 fuel oil heating, viscous materials, raw crude oil, residual oils, high temperature air and gas heating.

4 and 2 Watts Per Square Inch
For asphalt and other hard-to-heat substances, extra high temperature air and gas.



Heater Dimensional Drawing Data

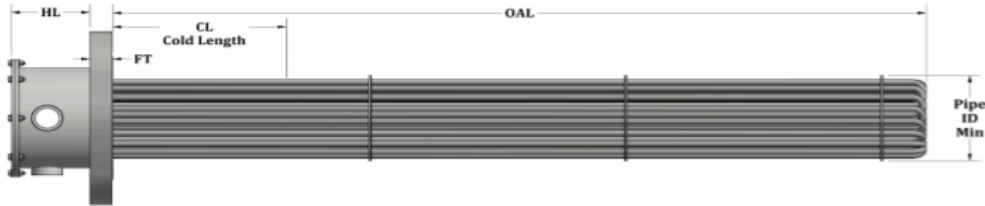

Housing Dimensions (HL)

Diameter	GP	LT	ER	Atex/IEC ex
2.50	2.63	2.63	5.50	7.00
3.00	2.63	2.63	5.50	7.00
4.00	5.50	5.50	6.50	8.00
5.00	5.50	5.50	6.50	9.00
6.00	5.50	5.50	8.00	11.00
8.00	5.50	5.50	9.00	11.00
10.00	7.00	7.00	11.00	11.00
12.00	7.00	7.00	11.00	11.00
14.00	7.00	7.00	11.00	11.50
16.00	9.00	9.00	13.00	11.50
18.00	9.00	9.00	13.00	11.50
20.00	9.00	9.00	13.00	11.50
24.00	11.00	11.00	15.00	11.50

Flange Dimensional Drawing Data

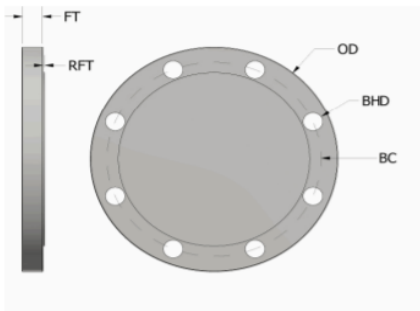

Dia	OD	FT	RFT	BC	BHD	Q BH
2.50	7.50	0.94	0.06	5.88	0.88	8.00
3.00	8.25	1.06	0.06	6.63	0.88	8.00
4.00	10.00	1.19	0.06	7.88	0.88	8.00
5.00	11.00	1.31	0.06	9.25	0.88	8.00
6.00	12.50	1.38	0.06	10.63	0.88	12.00
8.00	15.00	1.56	0.06	13.00	1.00	12.00
10.00	17.50	1.81	0.06	15.25	1.13	16.00
12.00	20.50	1.94	0.06	17.75	1.25	16.00
14.00	23.00	2.06	0.06	20.25	1.25	20.00
16.00	25.50	2.19	0.06	22.50	1.38	20.00
18.00	28.00	2.31	0.06	24.75	1.38	24.00
20.00	30.50	2.44	0.06	27.00	1.38	24.00
24.00	36.00	2.69	0.06	32.00	1.63	24.00