

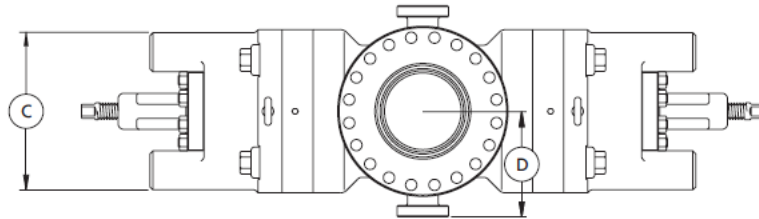

Single Open Faced Flange or Clamp Hub Dimensions

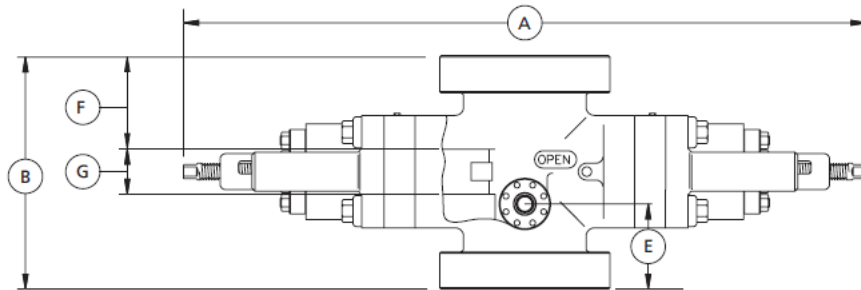

Top View Single or Double U BOP



Side View Single U BOP

Specifications

Size (in.)	Pressure Rating (psi)	Vertical Bore (in.)	A-1 (in.)	A-2 (in.)	A-3 (in.)	A-4 (in.)	B-1 (in.)	B-2 (in.)	C (in.)	E-1 (in.)	E-2 (in.)	F-1 (in.)	F-2 (in.)	G (in.)	Approx. Weight (lb)
7-1/16*	3000	7-1/16	74.00	109.50	-	-	24.06	-	20.25	8.75	-	7.84	-	5.50	2600
7-1/16*	5000	7-1/16	74.00	109.50	-	-	27.50	25.19	20.25	10.41	9.25	9.63	8.47	5.50	2800
7-1/16	10,000	7-1/16	74.00	109.50	-	-	30.56	27.19	20.63	11.06	9.38	12.03	10.34	5.50	3550
7-1/16	15,000	7-1/16	74.00	109.50	-	-	31.81	-	20.63	11.69	-	12.66	-	5.50	3800
11*	3000	11	96.25	146.88	-	-	29.06	-	25.13	9.81	-	10.53	-	6.75	5300
11*	5000	11	96.25	146.88	110.13	150.19	34.31	29.31	25.13	12.44	9.94	13.16	10.66	6.75	5600
11*	10,000	11	96.25	146.88	110.13	150.19	35.69	32.19	25.75	13.13	11.38	13.84	12.09	6.75	6400
11 Model 79	15,000	11	124.00	175.31	124.50	167.13	44.81	33.88	32.00	16.69	11.22	17.78	12.31	9.25	10,300
13-5/8	3000	13-5/8	112.13	171.50	122.69	166.06	31.31	-	29.25	10.31	-	11.53	-	7.50	7200
13-5/8	5000	13-5/8	112.13	171.50	122.69	166.06	33.81	31.94	29.25	11.56	10.63	12.78	11.84	7.50	7700
13-5/8	10,000	13-5/8	114.13	172.75	124.69	167.31	41.69	32.81	30.25	15.13	10.69	17.09	12.66	7.50	10,300
13-5/8 Model B*	15,000	13-5/8	139.00	214.38	152.25	205.50	53.69	42.00	39.50	21.38	15.50	22.84	17.00	8.00	23,700
16-3/4 Model B	3000	16-3/4	127.25	204.56	147.25	199.38	40.06	31.75	35.75	13.31	9.16	15.41	11.25	9.25	13,700
16-3/4 Model B	5000	16-3/4	129.25	202.13	149.25	202.25	43.06	34.94	35.75	14.81	10.75	16.91	12.84	9.25	13,750
16-3/4*	10,000	16-3/4	139.00	218.38	155.50	212.00	49.69	41.94	39.50	19.38	15.50	20.22	16.34	9.25	23,300
18-3/4	10,000	18-3/4	156.38	242.13	166.50	226.63	56.00	43.23	42.50	20.50	13.88	22.00	15.34	12.00	28,900
20-3/4	3000	20-3/4	143.69	226.81	163.94	223.88	40.56	33.31	39.52	14.31	10.69	16.28	12.66	8.00	13,650
21-1/4	2000	21-1/4	143.69	226.81	163.94	223.88	37.9	33.31	39.52	12.63	10.69	14.59	12.66	8.00	13,250
21-1/4	5000	21-1/4	164.25	247.25	180.94	239.25	50.94	46.13	42.50	17.97	17.19	18.72	14.69	13.50	30,000
21-1/4*	10,000	21-1/4	163.38	250.38	181.13	239.50	66.00	53.00	47.25	24.53	18.03	26.25	19.75	13.50	34,650
26-3/4	3000	26-3/4	169.63	275.38	-	-	48.31	-	46.25	17.44	-	19.91	-	8.00	24,000

* Available with stud X flange connection

Weights shown are for flange X flange top/bottom

Note: All weights listed are based on utilizing closed die forgings.