



Sheaves, Bushings & Belts

Sheaves

Drive: TW-25

Location	Datum Dia.	O.D.	I.D.	3 Groove- B Section						
				F= 2-1/2						
				E*	Type	Bush.	K	L	M	Wt.
Motor	5.0	5.35	3.62	7/16	A1	SD	1-1/16	1-13/16	1/4	8.10
Drive	20.0	20.35	18.50	1/16	D3	SF	5/8	2	9/16	45.70

*"E" Dimension varies according to shaft tolerance. Weights for all above are approximate and include the bushing. P.D. for "B" Belts =DD + .413 All Dimensions in Inches.

Drive: TW-30

Location	Datum Dia.	O.D.	I.D.	3 Groove – B Section						
				F= 2-1/2						
				E*	Type	Bush.	K	L	M	Wt.
Motor	5.0	5.35	3.62	7/16	A1	SD	1-1/16	1-13/16	1/4	8.10
Drive	20.0	20.35	18.50	1/16	D3	SF	5/8	2	9/16	45.70

*"E" Dimension varies according to shaft tolerance. Weights for all above are approximate and include the bushing. P.D. for "B" Belts =DD + .413 All Dimensions in Inches.

Drive: TW-50

Location	Datum Dia.	O.D.	I.D.	3 Groove – C Section						
				F=2-1/2						
				E*	Type	Bush.	K	L	M	Wt.
Motor	5.0	5.40	3.25	7/16	A1	SD	1-1/16	1-13/16	1-1/8	9.70
Drive	30.0	30.40	28.18	1/4	C3	F	13/16	3-5/8	0	129.10

*"E" Dimension varies according to shaft tolerance. Weights for all above are approximate and include the bushing. P.D. for "C" Belts is the same as diameter. All Dimensions in Inches.

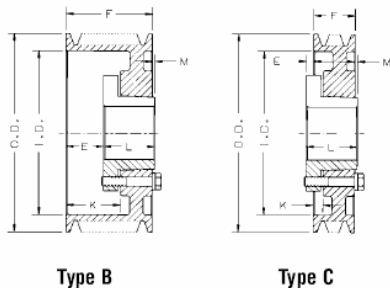

www.canamservices.com

245, 6025-12th Street SE, Calgary, AB, Canada T2H 2K1

E-mail: canam@canamservices.com

Tel: 1(403) 543-0350, Fax: 1(403) 543-0351





Sheaves, Bushings & Belts

Bushings

Torque Ratings & Dimensions											
Bush	Torque Capacity (In-Lbs)	Note 1 Max. Bore	Note 2 Max. Bore	Dimensions in Inches						Bolt Circle	Cap Screws Required
				A	B	D	E	F*	L		
SD	5,000	1-15/16	42	7/16	2.1875	3-3/16	1-3/8	1-1/4	1-13/16	2-11/16	3-1/4 x 1-7/8
SF	11,000	2-15/16	63	1/2	3.125	4-5/8	1-1/2	1-1/4	2	3-7/8	3-3/8 x 2
F	40,000	3-15/16	90	13/16	4.4375	6-5/8	2-13/16	2-13/16	3-5/8	5-5/8	3-9/16 x 3-5/8

Bore & Key Seat Dimensions			
Bushing Type	Bore	Key Seat	*WT
(Inches)			
SD (TW-25 Motor)	1-5/8	3/8 x 3/16	1.2
SD (TW-30 Motor)	1-5/8	3/8 x 3/16	1.2
F (TW-50 Motor)	2-1/2	5/8 x 5/16	13.9
SF (TW-50 Drive)	2-1/4	1/2 x 1/4	3.1
(Metric)			
SF (TW-25 Drive)	55	16 x 10	3.2
SF (TW-30 Drive)	55	16 x 10	3.2

*Approximate Weight in Lbs.

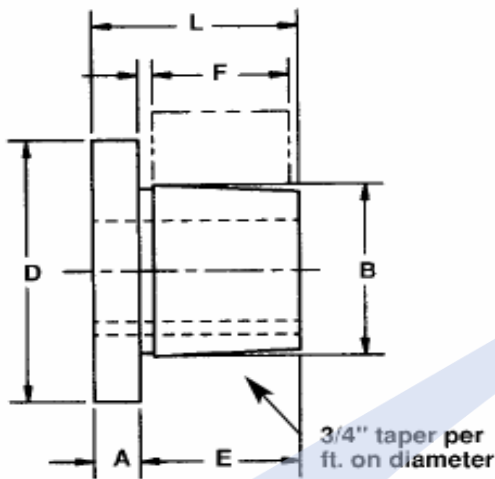

www.canamservices.com

245, 6025-12th Street SE, Calgary, AB, Canada T2H 2K1

E-mail: canam@canamservices.com

Tel: 1(403) 543-0350, Fax: 1(403) 543-0351





Sheaves, Bushings & Belts

Banded V-Belts

Banded V-Belt Features

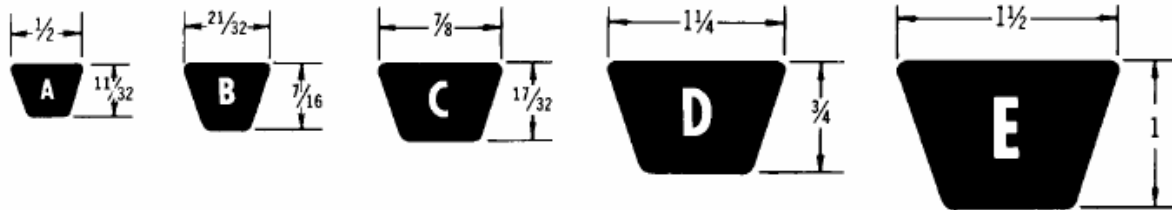

Banded V-belts are the finest wrapped belts in industry and are designed to provide premium performance at standard prices. The belts have a specially constructed cover fabric for optimum flexibility and abrasion resistant characteristics.

Belts perform their best when operating on sheave diameters no smaller than RMA/MPTA recommended: A = 3.0, B = 5.4, C = 9.0, D = 13.0, and E = 21.6.

Banded V-belts have all the same features as a standard wrapped belt, but with the added benefit of multiple belts in a single belt. Should be considered for those problem drives where long center distance, vibration, pulsating or shock loads cause individual belts to whip, turn over, or jump out of sheave grooves. B and C belts available in 2 thru 5 ribs and D belts available in 3 thru 5 ribs.

The Banded V-Belts used with both the TW-25 & TW-50 Twister Drive Assemblies are 3 Rib Banded Belts.

Branded V-Belts		
Size	Datum Length	Weight Lbs.
3RB96 (B Section) (TW-25 Drive)	97.8	3.9
3RB96 (B Section) (TW-30 Drive)	97.8	3.9
3RC96 (C Section) (TW-50 Drive)	98.9	6.6

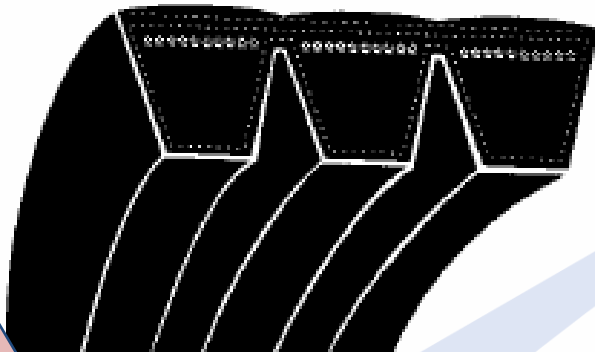

www.canamservices.com

245, 6025-12th Street SE, Calgary, AB, Canada T2H 2K1

E-mail: canam@canamservices.com

Tel: 1(403) 543-0350, Fax: 1(403) 543-0351

