

## LINK SPECIFICATIONS

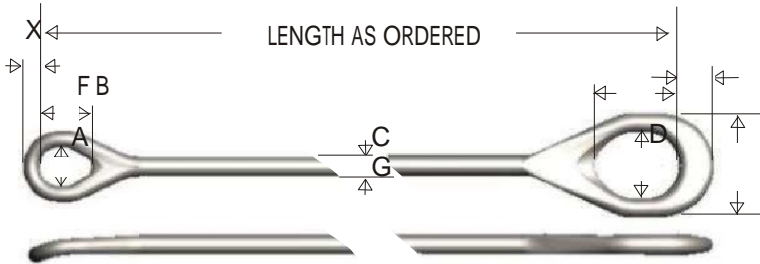

### ELEVATOR LINK DIMENSIONAL DATA

X	A	B	C	D	E	F	G
2 1/4	5 1/2	8	2 7/8	9 1/2*	12*	5	15
2 3/4	5 1/2	8	3 1/2	9 1/2*	12*	5	15
3 1/2	6 3/4	10 1/8	4 1/2	9 1/2	12	6	17
4 3/4	7 1/2	12 1/2	5 1/2	9 1/2	12	7 1/4	19

\* Big Eye - current production, previous production was 8" x 10"

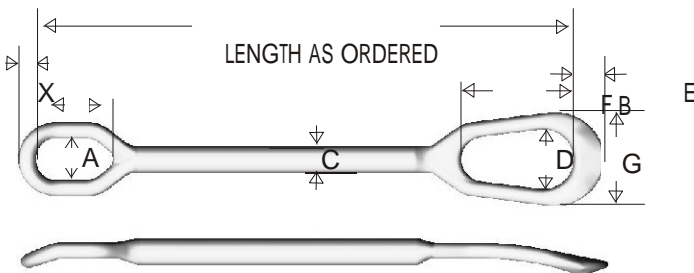

### "WORK OVER" LINK DIMENSIONAL DATA

X	A	B	C	D	E	F	G
1 3/4	4	5 1/2	2 7/8	5	13 3/8	3 1/2	8 1/2

PART NO.	LENGTH	RATED CAP. PER WT PER SET	
		[TONS]	SET
17536	36	150	215
17548	48	150	250
17560	60	150	280
17572	72	150	320
17584	84	150	360
17596	96	150	400
175108	108	150	440
22560	60	250	480
22572	72	250	530
22584	84	250	580
22596	96	250	630
225108	108	250	680
225120	120	250	700
225132	132	250	780
225144	144	250	875
225168	168	250	900
275108	108	350	870
275120	120	350	935
275132	132	350	1000
275144	144	350	1095
275180	180	350	1255
275192	192	350	1320
275216	216	350	1450
275240	240	350	1580
350108	108	500	1450
350132	132	500	1670
350144	144	500	1780
350160	160	500	1927
350168	168	500	2000
350180	180	500	2118
350192	192	500	2202
350264	264	500	2882
475120	120	750	3426
475144	144	750	3828
475160	160	750	4230
475180	180	750	4564
475216	216	750	5166
475240	240	750	5568
475264	264	750	5970

1000 TON AND SPECIAL LENGTHS AVAILABLE